



Integral solder ring fittings

Integral Solder Ring fittings are manufactured from copper and copper alloy. Fittings are designed for joining copper tubes to BS/EN/1057 in potable hot and cold water services, in small bore and minibore central heating, low pressure steam heating, and in vented and unvented closed circuit heating systems.



- Manufactured to **BS/EN/1254 part 1**
- Integral solder ring potable performance when correctly assembled with copper tube to BS/EN/1057

Size	Service temperature			
	Min -40°C	30°C	65°C	Max 110°C
6-54mm	16 bar	16 bar	10 bar	6 bar

CB ISR straight coupling

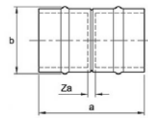

Code	Size	a	b	Za
543901	8mm	20	11	2
543902	10mm	22	13	2
543903	15mm	30	19	2
543904	22mm	40	26	2
543905	28mm	47	33	3
543906	35mm	59	40	2
543907	42mm	65	47	2
543908	54mm	77	60	2

CB ISR slip straight coupling

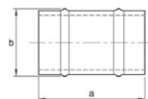

Code	Size	a	b
543913	15mm	30	19
543914	22mm	40	26

CB ISR reducing coupling

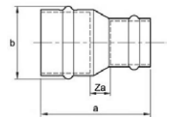

Code	Size	a	b	Za
543924	22-15mm	40	26	6
543925	28-22mm	48	33	7

CB ISR FI straight connector

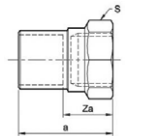

Code	Size	a	b	Za
543933	15mm x 1/2"	38	20	26
543923	22mm x 3/4"	38	20	31

CB ISR MI straight connector

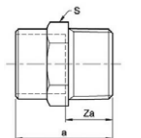

Code	Size	a	b	Za
543943	15mm x 1/2"	33	19	24
543944	22mm x 3/4"	37	18	29
543945	28mm x 1"	43	21	37



CB ISR reducer

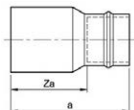

Code	Size	a	Za
543952	10 x 8mm	25	13
543953	15 x 8mm	31	21
543954	15 x 10mm	31	22
543955	22 x 15mm	41	26
543956	28 x 15mm	48	33
543957	28 x 22mm	49	30
544148	35 x 15mm	54	42
544149	35 x 22mm	58	58
544150	35 x 28mm	54	33
544151	42 x 15mm	72	57
544152	42 x 22mm	70	48
544157	42 x 28mm	67	43
544158	42 x 35mm	66	38
544159	54 x 15mm	86	71
544160	54 x 22mm	75	55
544161	54 x 28mm	81	58
544162	54 x 35mm	81	52
544163	54 x 42mm	78	48

CB ISR 90° elbow

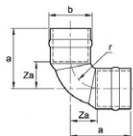

Code	Size	a	b	Za	r
543963	8mm	18	11	8	10
543964	10mm	21	12	10	12
543965	15mm	26	19	12	12
543966	22mm	36	27	16	26
543967	28mm	41	32	19	34
543968	35mm	50	40	22	25
543969	42mm	58	48	27	49
543970	54mm	71	60	34	63

CB ISR 90° street elbow

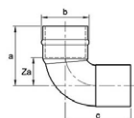

Code	Size	a	b	Za	r
543973	15mm	29	19	35	14
543974	22mm	43	27	45	22
543975	28mm	40	32	44	19
543976	35mm	50	40	52	23
543977	42mm	58	49	65	26

CB ISR backplate elbow

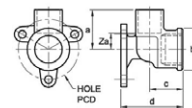

Code	Size	a	b	c	d	PCD	Za
544173	15 x 1/2"	26	28	31	41	35	11

CB ISR 45° elbow

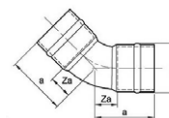

Code	Size	a	b	Za
543983	15mm	22	19	8
543984	22mm	29	26	10
543995	28mm	38	33	15
543996	35mm	42	40	14
543997	42mm	47	48	15
543998	54mm	56	60	19

CB ISR equal tee

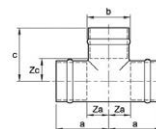

Code	Size	a	b	c	Za	Zc
544113	15mm	24	19	24	10	10
544114	22mm	32	26	32	13	13
544115	28mm	38	33	38	16	16
544116	35mm	49	40	49	20	20
544117	42mm	56	48	56	25	25
544118	54mm	65	60	65	30	30

CB ISR reducing tee

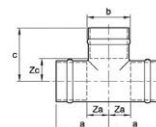

Code	Size	a	b	c	Za	Zc
544123	22x22x15mm	28	26	27	9	13
544124	28x28x15mm	33	32	31	10	16
544125	28x28x22mm	36	33	37	14	17
544135	35x35x15mm	39	41	37	12	23
544136	35x35x22mm	43	41	41	16	22
544137	35x35x28mm	43	40	45	15	24
544138	42x42x15mm	47	48	47	15	31
544139	42x42x22mm	45	48	44	13	23
544140	42x42x28mm	47	48	46	15	24
544141	42x42x35mm	53	48	53	22	25
544142	54x54x15mm	48	61	48	9	34
544144	54x54x22mm	52	60	49	13	30
544145	54x54x28mm	54	59	52	17	30
544146	54x54x35mm	57	60	56	21	29
544147	54x54x42mm	61	60	64	24	32

CB ISR tee, one end reduced

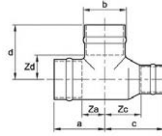

Code	Size	a	b	c	d	Za	Zc	Zd
544126	22x15x22mm	32	26	36	32	14	22	13
544127	28x22x28mm	38	32	42	39	15	22	17

CB ISR tee, one end and branch reduced

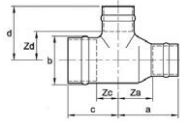

Code	Size	a	b	c	d	Za	Zc	Zd
544134	22x15x15mm	33	26	33	28	19	11	14

CB ISR tee, both ends reduced

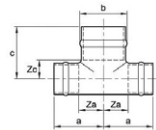

Code	Size	a	b	c	Za	Zc
544133	15x15x22mm	37	26	21	23	12

CB ISR FI tee

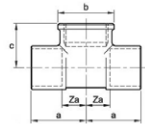

Code	Size	a	b	c	Za
544143	15x15x1/2"	25	28	22	11

CB ISR stop end

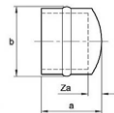

Code	Size	a	b	Za
543991	8mm	14	11	5
543992	10mm	14	13	3
543993	15mm	16	19	2
543994	22mm	21	26	2
543985	28mm	24	32	2
543986	35mm	32	40	2
543987	42mm	36	48	3
543988	54mm	41	60	2

CB ISR straight tap connector

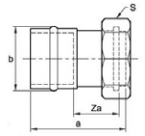

Code	Size	a	b	Za	S
544153	15mm x 1/2"	37	19	16	24
544154	15mm x 3/4"	37	19	18	31
544155	22mm x 3/4"	48	26	26	30

CB ISR straight union adaptor

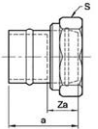

Code	Size	a	Za	S
544164	22 x 1"	35	13	37

CB ISR bent tap connector

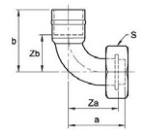

Code	Size	a	b	c	Za	Zc
544156	15 x 1/2"	37	26	21	23	12

The information contained on this page was correct at date of issue. Fitting dimensions are provided as a guide only. Some variation may occur due to manufacturing tolerances. We pursue a policy of continuing improvement in design and performance of products and so reserve the right to change specifications without prior notice.

Version number 1.0

